

GPS&GLONASS+GSM Combination Antenna VTGLMA-8

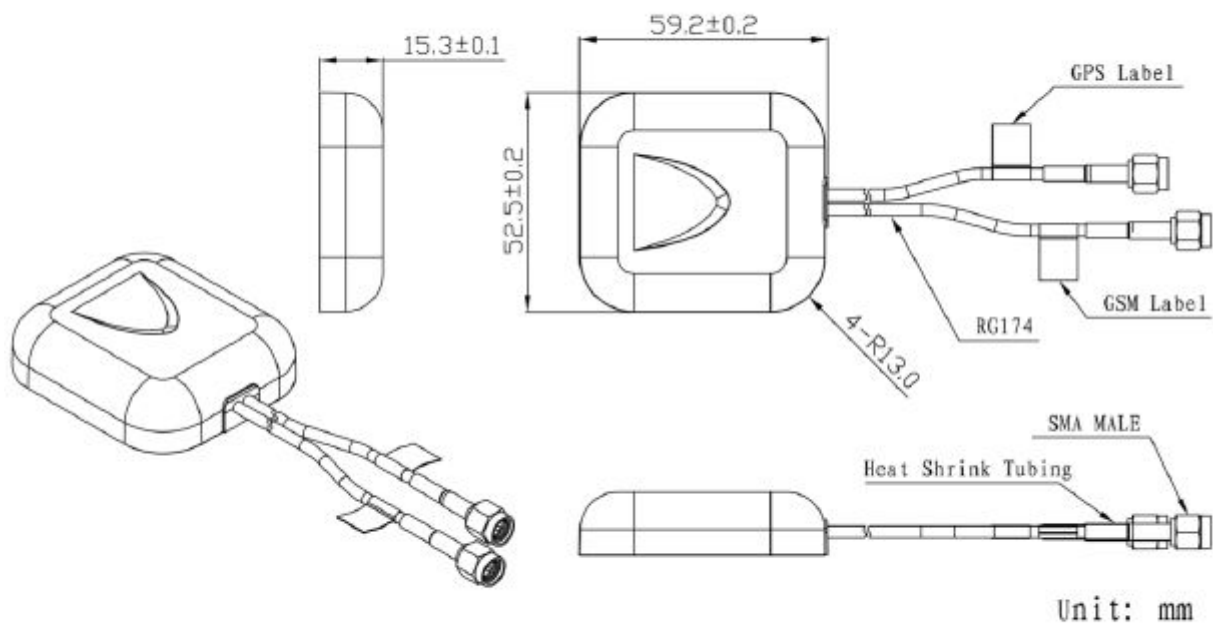

DIMENSIONS



SPECIFICATIONS

| | |
|------|--|
| Item | |
|------|--|

| | | | |
|---------------------|--------------------|-----------------------|---------------------------------|
| GPS Antenna | Dielectric Antenna | Center Frequency | 1595±3MHz |
| | | Band Width | CF±5MHz |
| | | Polarization | RHCP |
| | | Gain | 5dBic (Zenith) |
| | | V.S.W.R | <1.5 |
| | | Impedance | 50Ω |
| | LNA | Gain | 28±2dB |
| | | Noise Figure | <1.5 |
| | | Ex-band Attenuation | 12dB@CF+50MHz/16dB@CF-50MHz |
| | | V.S.W.R | <2.0 |
| | | Supply Voltage | 2.2~5V DC |
| Current Consumption | 5~15mA | | |
| GSM Antenna | | Frequency Range | 824~960MHz/1710~2170MHz |
| | | V.S.W.R | <2.0 |
| | | Polarization | Linear |
| | | Gain | 2.0dBi |
| | | Impedance | 50Ω |
| Mechanical | | Cable | RG174 |
| | | Connector | SMA/MCX/FAKRA or others |
| | | Material | ABS |
| | | Mounting Method | Magnetic/Stick |
| Environmental | | Operating Temperature | -40℃~+85℃ |
| | | Relative Humidity | Up to 95% |
| | | Ingress Protection | IP67 (exclude cable outlet) |
| | | Vibration | 10 to 55Hz with 1.5mm amplitude |
| | | Environmentally | ROHS Compliant |

Radication Pattern

GPS Antenna

V.TORCH

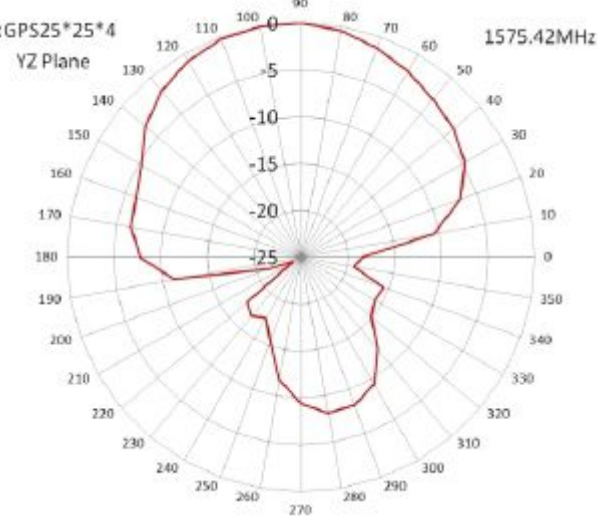
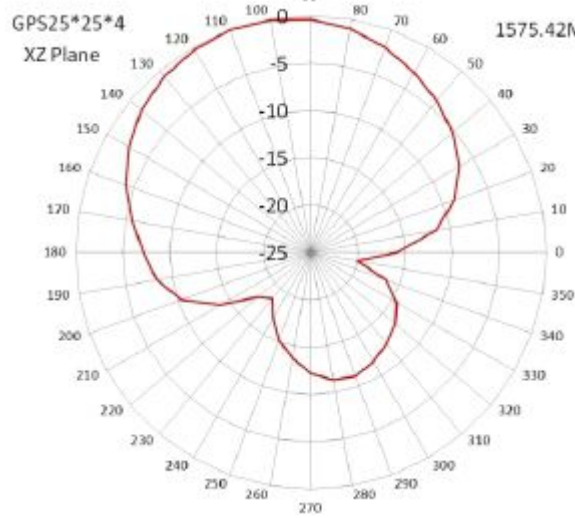
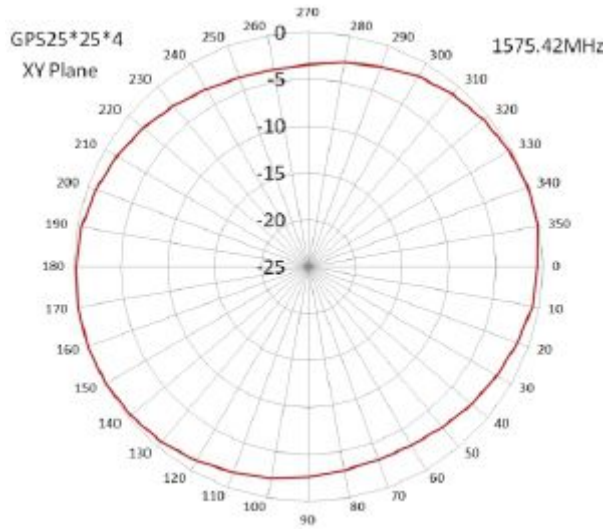

GSM Antenna

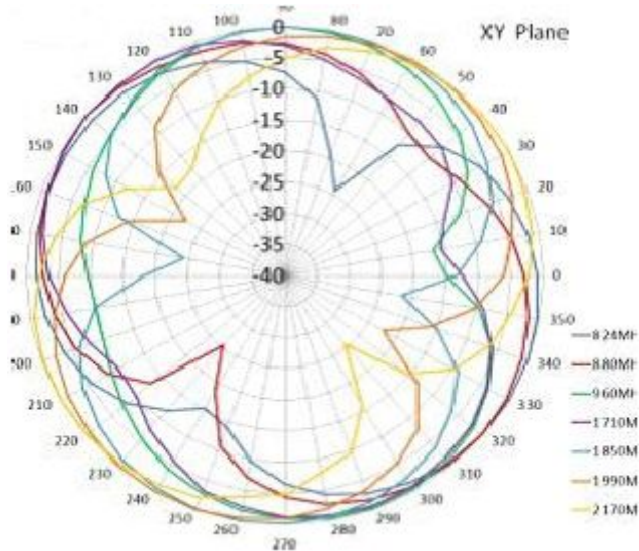

V.TORCH

